

**9022CA**  
2-hole corner angle  
1-7/8" x 2"

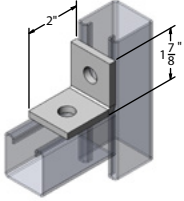

Materials/Finishes:	Zinc Plated (9022CAZ)
	T-304 Stainless (9022CASS)
	T-316 Stainless (9022CASX)
Thickness:	1/4"
Hole Dim:	9/16"
Wgt. each (lbs)	.37

**9024CA**  
2-hole corner angle  
w/ guides  
2-1/8" x 2-1/8"

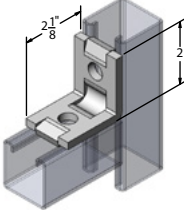

Materials/Finishes:	Zinc Plated (9024CAZ)	
	Thickness:	1/4"
	Hole Dim:	9/16"
	Wgt. each (lbs)	.41

**9026CA**  
3-hole corner angle  
2-1/4" x 3-1/2"

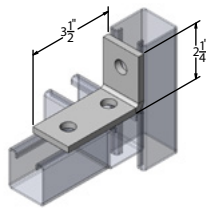

Materials/Finishes:	Zinc Plated (9026CAZ)
	T-304 Stainless (9026CASS)
	T-316 Stainless (9026CASX)
Thickness:	1/4"
Hole Dim:	9/16"
Wgt. each (lbs)	.56

**9028CA**  
3-hole corner angle  
1-7/8" x 3-7/8"

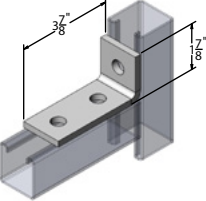

Materials/Finishes:	Zinc Plated (9028CAZ)	
	Thickness:	1/4"
	Hole Dim:	9/16"
	Wgt. each (lbs)	.58

**9030CA**  
4-hole corner angle  
4-1/8" x 3-1/2"

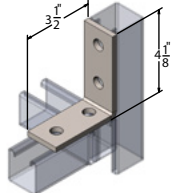

Materials/Finishes:	Zinc Plated (9030CAZ)
	T-304 Stainless (9030CASS)
	T-316 Stainless (9030CASX)
Thickness:	1/4"
Hole Dim:	9/16"
Wgt. each (lbs)	.78

**9032CA**  
4-hole webbed  
corner angle, r.h.  
4-1/8" x 3-1/2"

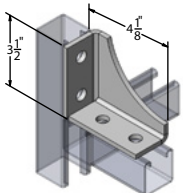

Materials/Finishes:	Zinc Plated (9032CAZ)	
	Thickness:	1/4"
	Hole Dim:	9/16"
	Wgt. each (lbs)	1.12

**9023CA**  
2-hole corner angle  
2-1/4" x 1-5/8"

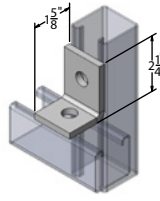

Materials/Finishes:	Zinc Plated (9023CAZ)	
	Thickness:	1/4"
	Hole Dim:	9/16"
	Wgt. each (lbs)	.37

**9025CA**  
1-hole adjustable corner angle  
w/ slot  
2" x 2-5/8"

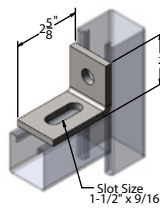

Materials/Finishes:	Zinc Plated (9025CAZ)	
	Thickness:	1/4"
	Hole Dim:	9/16"
	Wgt. each (lbs)	.38

**9027CA**  
3-hole corner angle  
4-1/8" x 1-5/8"

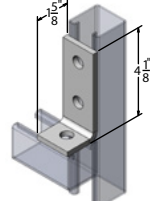

Materials/Finishes:	Zinc Plated (9027CAZ)
	T-304 Stainless (9027CASS)
	T-316 Stainless (9027CASX)
Thickness:	1/4"
Hole Dim:	9/16"
Wgt. each (lbs)	.56

**9029CA**  
2-hole adjustable corner angle  
w/ slot  
3-7/8" x 2-5/8"

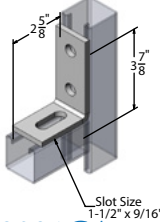

Materials/Finishes:	Zinc Plated (9029CAZ)	
	Thickness:	1/4"
	Hole Dim:	9/16"
	Wgt. each (lbs)	.61

**9031CA**  
4-hole corner angle  
3-3/4" x 3-7/8"

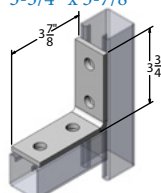

Materials/Finishes:	Zinc Plated (9031CAZ)
	T-304 Stainless (9031CASS)
	T-316 Stainless (9031CASX)
Thickness:	1/4"
Hole Dim:	9/16"
Wgt. each (lbs)	.76

**9033CA**  
4-hole webbed  
corner angle, l.h.  
3-1/2" x 4-1/8"

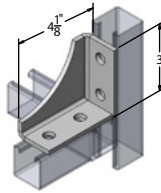

Materials/Finishes:	Zinc Plated (9033CAZ)	
	Thickness:	1/4"
	Hole Dim:	9/16"
	Wgt. each (lbs)	1.12

**9034CA**  
7-hole universal  
corner angle  
4-1/8" x 4-1/8"

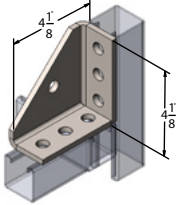

Materials/Finishes:	Zinc Plated (9034CAZ)
Thickness:	1/4"
Hole Dim:	9/16"
Wgt. each (lbs)	1.32

**9035CA**  
3-hole shelf gusset angle  
1-5/8" x 2-1/4"

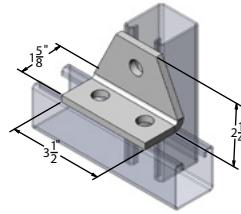

Materials/Finishes:	Zinc Plated (9035CAZ)
Thickness:	1/4"
Hole Dim:	9/16"
Wgt. each (lbs)	.67

**9036CA**  
4-hole shelf gusset angle  
1-5/8" x 4-1/8"

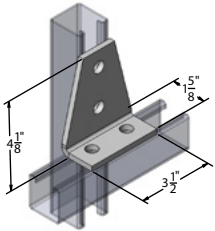

Materials/Finishes:	Zinc Plated (9036CAZ)
Thickness:	1/4"
Hole Dim:	9/16"
Wgt. each (lbs)	1.02

**9037CA**  
4-hole shelf gusset  
3-way angle  
2-1/4" x 3-1/2"

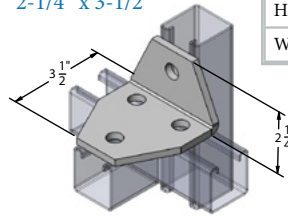

Materials/Finishes:	Zinc Plated (9037CAZ)
Thickness:	1/4"
Hole Dim:	9/16"
Wgt. each (lbs)	1.01

**9038CA**  
5-hole shelf gusset  
3-way angle  
4-1/2" x 3-1/2"

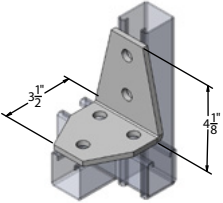

Materials/Finishes:	Zinc Plated (9038CAZ)
Thickness:	1/4"
Hole Dim:	9/16"
Wgt. each (lbs)	1.35

**9039CA**  
5-hole shelf gusset angle  
1-5/8" x 4-1/8"

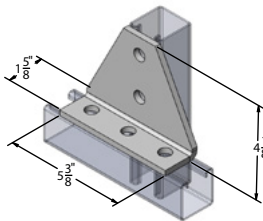

Materials/Finishes:	Zinc Plated (9039CAZ)
Thickness:	1/4"
Hole Dim:	9/16"
Wgt. each (lbs)	1.41

**9040CA**  
2-hole 45° knee brace 12"

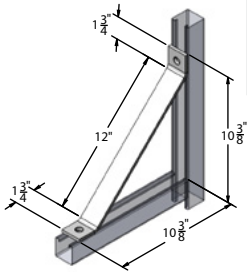

Materials/Finishes:	Zinc Plated (9040CAZ)
Thickness:	1/4"
Hole Dim:	9/16"
Wgt. each (lbs)	1.65

**9042CA**  
2-hole 45° knee brace 18"

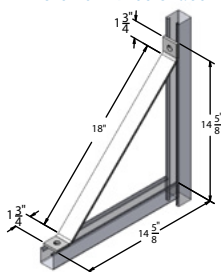

Materials/Finishes:	Zinc Plated (9041CAZ)
Thickness:	1/4"
Hole Dim:	9/16"
Wgt. each (lbs)	2.34

**9043CA**  
2-hole 45° knee brace 24"

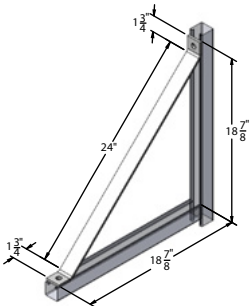

Materials/Finishes:	Zinc Plated (9043CAZ) T-304 Stainless (9043CASS) T-316 Stainless (9043CASX)
Thickness:	1/4"
Hole Dim:	9/16"
Wgt. each (lbs)	3.03

PROJECT INFORMATION			APPROVAL STAMP
Project:			Notes:
Address:			
Contractor:			
Engineer:			
Date:			
Approved	Approved as Noted	Not Approved	